

# Lux-May

## Serie PRZ-IP65



DISPONIBLE



**Nota: Antes de manipular la luminaria lea detenidamente la totalidad del manual.**  
Note: Before start managing the luminaire read the whole manual carefully.

### ATENCIÓN / WARNING

1. **Las luminarias deben ser manipuladas por personal profesional cualificado.**  
Luminaires must be manipulated by qualified professional staff.
2. **Antes de efectuar cualquier manipulación en la luminaria, asegúrese de que la corriente eléctrica se encuentra desconectada.**  
Disconnect electricity supply before any installation or servicing work.

### ADVERTENCIAS / GENERAL

1. **Válido para uso interior.**  
Suitable for indoor use.
2. **Mantener una distancia mínima de 0,2m de cualquier material inflamable.**  
Products should be kept a distance at least 0.2m with flammable materials.
3. **La conexión debe realizarse utilizando los accesorios suministrados con la luminaria, asegurando su firmeza.**  
The connection must be made using the accessories supplied with the luminaire, ensuring its firmness.

### PRZ/OP-IP65

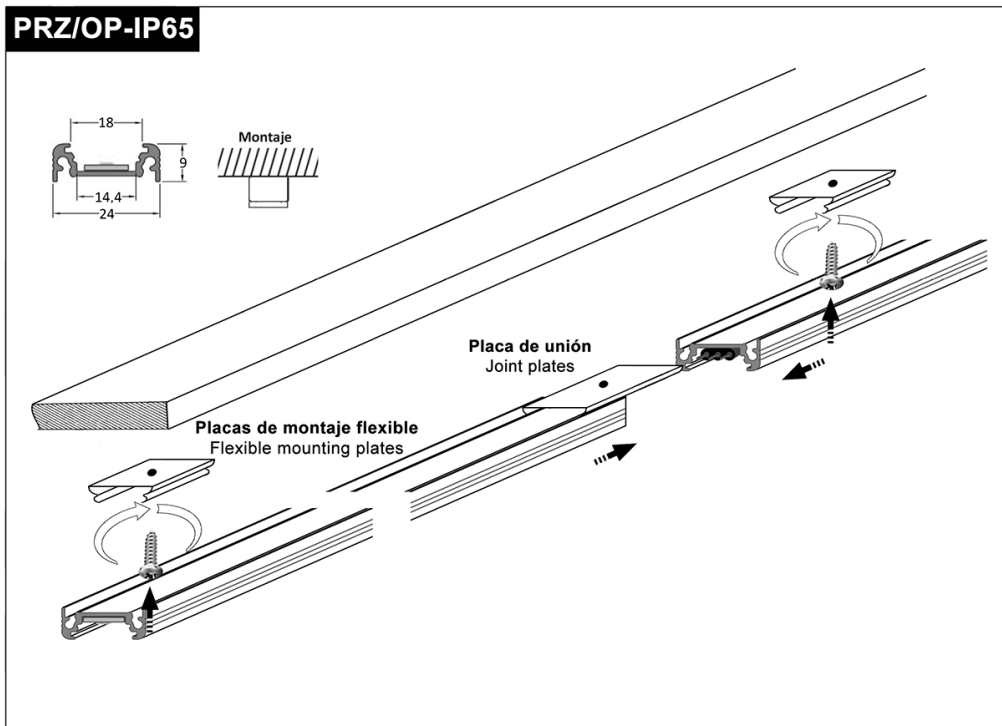

# PRZ/OPE-IP65

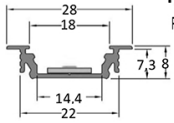

**Techo escayola + acc. adosar**  
Plaster ceiling + surface acc.

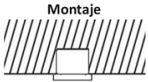

**Placas de montaje flexible**  
Flexible mounting plates

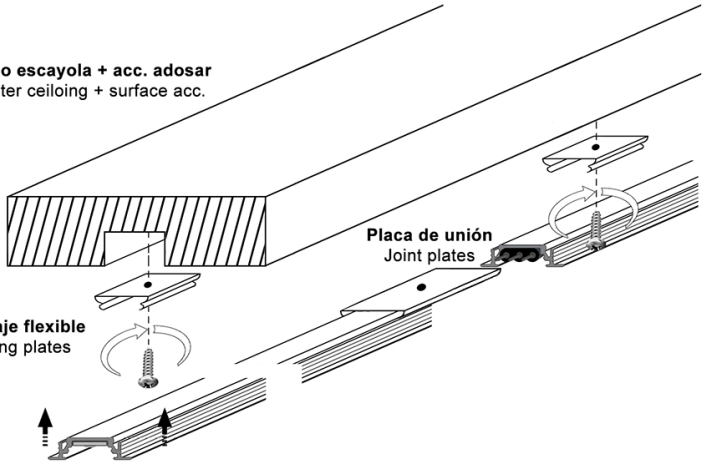

**Techo pladur**  
Plasterboard ceiling

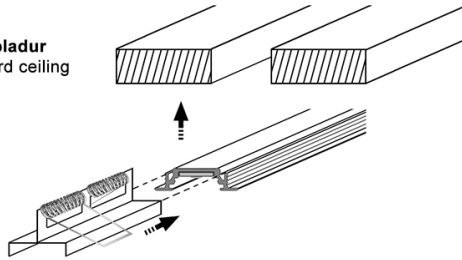

# ANG-IP65

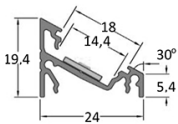

Montaje

**Placas de montaje flexible**  
Flexible mounting plates

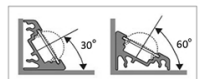
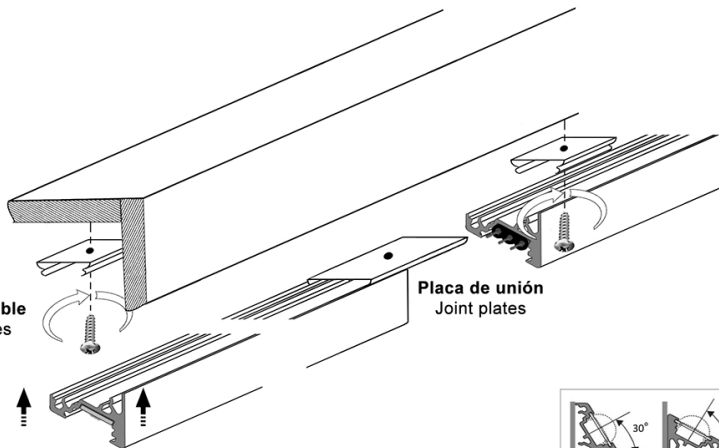

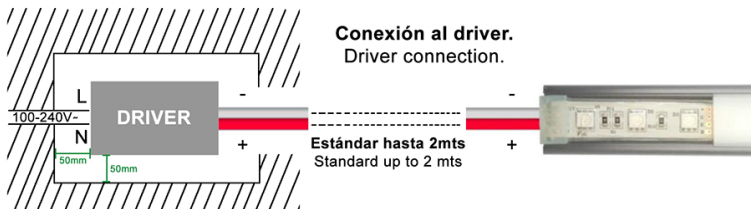

**Las tiras de LED IP65 8mts máximo.**  
LED strip IP65 8 mts max.

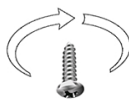

**Pegar la tira LED al perfil.**  
Stick the LED strip to the profile.



**Tapas**  
Covers



**Placas de montaje flexible**  
Flexible mounting plates